

ADD-ON DEVICE

Quickstart Guide

Alarm Keypad

Model No. KYP1300

What's inside:

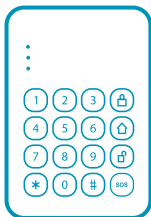

1x Alarm Keypad



**2x Double-Sided
Tapes**



**Mounting
Accessories**

Broadband internet connection, iOS or Android phone and home router required.

認識裝置

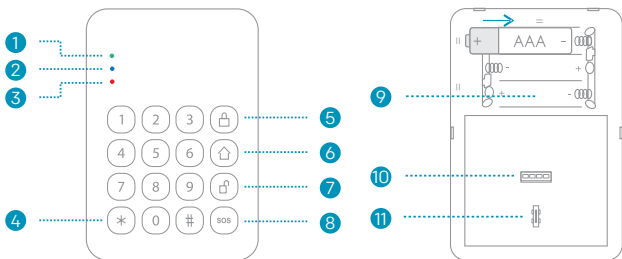

1. 綠色 LED 燈

長亮：
裝置上電

2. 藍色 LED 燈

閃爍一次：
更換模式

3. 紅色 LED 燈

閃爍一次：
操作錯誤
每三秒閃爍一次：
低電量指示，請盡速更換電池。

4. 喚醒鍵

5. 告警

6. 居家模式

7. 解除告警

8. 緊急按鈕

9. 電池槽

10. 有線接口

11. 防拆鍵

當背蓋被打開會觸發防拆裝置

12. 螺絲孔

13. 背蓋

14. 有線接口

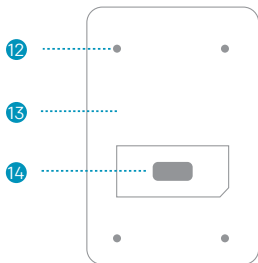

步驟一：組裝裝置與配件

1. 取出包裝內所有的裝置及配件。
2. 為維持穩定的連線品質，請在距離安全主機 (Security Shuttle) 1-10 呎 (30-300 公分) 處進行配對。
3. 拉出並移除裝置上的電池絕緣塑膠片。



步驟二：新增裝置

1. 開啟 app，點選側邊選單圖示 " ≡ "，並選擇 " 裝置管理 "。
2. 點選 " 感測器列表 " 旁的新增案鈕 "+"。
3. 遵照 app 上的指示掃描裝置上的 QR code。

請注意：若是掃描不成功，您將會被要求輸入裝置的序列號碼 (SN)。

步驟三：裝設裝置

在裝設裝置之前，請檢查裝置是否在安全主機的訊號溝通範圍內。

1. 將裝置拿到你要使用的地方。
2. 按壓 "*" 後長按 "SOS" 鍵 3 秒，如果收到 "緊急事件" 的推播通知，表示該裝置已經在溝通訊號範圍內，你可以開始裝設。

裝設

1

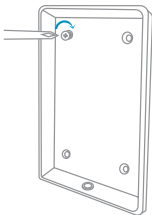

打開背蓋並安裝在適當的位置。

2

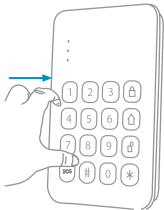

將裝置安裝到背蓋上。

3

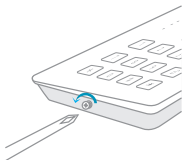

將底部螺絲鎖上。

操作

按"*"鍵將裝置喚醒後，輸入**管理者密碼 + #** 或 **使用者密碼 + #** 來進行操作。



*

+

管理者密碼 / 使用者密碼

+

#

- **管理者密碼**預設為 **123456**
- **使用者密碼**預設為 **1234**

註：若按"*"鍵後 5 秒內無任何動作，裝置會自動離開操作模式。

功能	指令
告警	按 * + 1234 + 
居家模式	按 * + 1234 + 
解除告警	按 * + 1234 + 

功能	指令
單警報模式	按  鍵後一秒內按  鍵可進入單警報模式 - 只有緊急事件會觸發警報。
取消單警報模式	按  鍵後一秒內按  鍵可取消單警報模式。
SOS 緊急按鈕	長按 SOS 鍵三秒可立即發送緊急通知。

註：建議將此功能設定為**須密碼才能啟動**，可避免誤觸。詳見設定單元。

設定

按 "*" 鍵後，輸入 **管理者密碼 + # + 9** 可進入設定狀態。藍色 LED 燈將長亮。再輸入指令。



- **管理者密碼**預設為 **123456**
- 聽到裝置發出一聲長響代表設定成功。

註：若 30 秒內無任何操作，裝置會自動離開設定模式。

功能	指令	註解
開啟 快速告警	* 1 #	啟用時，無須輸入密碼，使用者可直接按"* +  "來告警系統。
關閉 快速告警	* 1 *	—
開啟 按鍵聲	* 2 #	—
關閉 按鍵聲	* 2 *	啟用時，按壓按鍵時，綠色 LED 燈會閃動。
開啟 密碼緊急呼救	* 4 #	—
無密碼緊急呼救	* 4 *	—
更改 管理者密碼	* 新密碼 #	6 位數
更改 使用者密碼	* 新密碼 #	4 位數
延遲告警	0-99 秒 #	(0-99 秒)

Troubleshooting Tips

Are your devices listed in your app?

If you're having trouble installing your devices, see if they're listed in your app:

- Navigate to  > **Device Management** to see if all your devices are listed.
- Tap + next to the device category and follow the on-screen instructions to add any missing devices.

Are your devices communicating with Security Shuttle?

- If your devices don't connect to Security Shuttle, they might be too far away. Take them to a location that's closer to Security Shuttle and try again.
- If they do connect, you'll know the range of your device and where to install a range extender.
- Alternatively, you can move Security Shuttle closer to your device.
- If your devices still don't communicate with Security Shuttle, even when they're in the same room, navigate to  > **Device Management** > + on the app to add your devices again.

Reset to Default Settings

Press the Tamper Switch 5 times in a row, then you will heard one long beep.

FCC STATEMENT

1. This device complies with Part 15 of the FCC Rules. Operation is subject to the following two conditions:

(1) This device may not cause harmful interference, and (2) This device must accept any interference received, including interference that may cause undesired operation.

2. Changes or modifications not expressly approved by the party responsible for compliance could void the user's authority to operate the equipment.

This equipment has been tested and found to comply with the limits for a Class B digital device, pursuant to part 15 of the FCC Rules. These limits are designed to provide reasonable protection against harmful interference in a residential installation. This equipment generates, uses and can radiate radio frequency energy and, if not installed and used in accordance with the instructions, may cause harmful interference to radio communications. However, there is no guarantee that interference will not occur in a particular installation. If this equipment does cause harmful interference to radio or television reception, which can be determined by turning the equipment off and on, the user is encouraged to try to correct the interference by one or more of the following measures:

- Reorient or relocate the receiving antenna.
- Increase the separation between the equipment and receiver.
- Connect the equipment into an outlet on a circuit different from that to which the receiver is connected.
- Consult the dealer or an experienced radio/ TV technician for help.



99200307MIG