

Step 1 : Assemble your Device and Accessories

Unpack all of your hardware in the same room as your home router.

Package Contents :

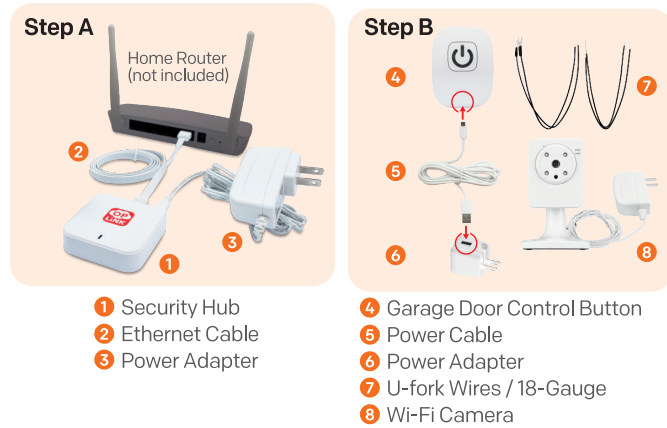

System equipped with Oplink and Mivalife components.

Step A: a. Connect ② Ethernet Cable between the ① Security Hub* and your home router.
b. Plug in ③ Power Adapter.

Step B: a. During system activation, please keep the ④ Garage Door Control Button and ⑧ Wi-Fi Camera close to the Security Hub. (less than 10ft away).
b. Connect the Garage Door Control button to the ⑤ ⑥ power adapter and plug it in.
c. Connect the included power adapter to the Wi-Fi Camera and plug it in.

* The Security Hub needs to be placed on a 3-5ft (0.91-1.52m) high platform for the best communication signal.

Step 4 : Choose your installation method

Review the installation options below and refer to the user manual for your specific garage door opener.

For more information, including a list of compatible garage door openers, please visit home8alarm.com/faq

Garage Door Control Button

Option 1: Use it with your existing wall switch

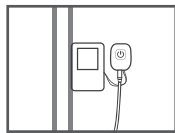

With existing wall switch

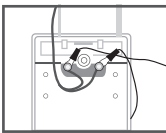

Attach ⑦ U-fork wires

- Unscrew your existing garage door wall switch.
- Locate the two wires that connect to your garage motor. Loosen the screws that hold them in place.
- Attach one ⑦ U-fork wire under each screw and tighten.
- Re-mount your existing wall switch.

Option 2: Replace your existing wall switch

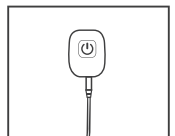

Replacing existing switch

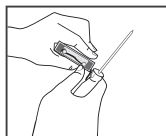

Remove switch completely

- Unscrew your existing garage door wall switch.
- Locate the two wires that connect to your garage motor. Loosen the screws that hold them in place.
- Remove your garage door wall switch completely.
- Continue to step 5.

Option 3: Attach it to your garage door motor

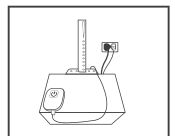

Attached to motor

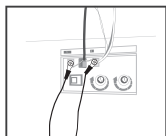

Wire to garage door motor

- Access the wire panel on your garage door motor unit.
- Locate the two wires that connect to your garage door wall switch. If you have trouble finding them, please refer to the user manual of your garage door motor to determine which wires connect to your wall switch. Or give us a call, we'll be happy to help.

Step 2 : Set up your Smartphone

Next:

1. Connect your Smartphone to Wi-Fi.
2. Download the Home8 app from the App Store, Google Play, or Windows store.
3. Follow the steps to create an account.
4. Follow the instructions for OPU/Shuttle Setup.



Download on the App Store

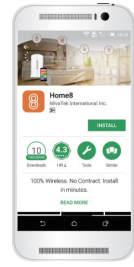

GET IT ON Google Play



Download from Windows Store

Step 3 : Cloud-Device Activation (CDA)

1. Tap the "Activate Now" button.
(Activation process takes approximately 2 minutes)

Note : When the automatic activation process fails, the app will advise you to scan the Security Hub QR code, located at the bottom of the device to continue.

2. When you see "System is ready!", the system CDA is complete.



Step 5 : Connect and test the range of your device

1. Insert the loose wires into the bottom of the garage door control button (one per hole, the order doesn't matter).
2. Power on the Garage Door Control Button and mount it with the included screws or double-sided tape.
3. In the Home8 app, navigate to **Automation** > **Garage Door Opener** and press the red power button. Your app should be able to operate your garage door.

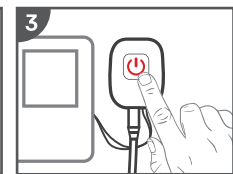
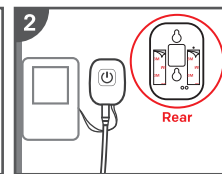
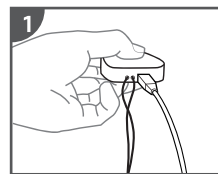

Wi-Fi Camera

Access your Home8 app, tap on the Video, wait until you see live streaming video from the app, it is connected to the system.

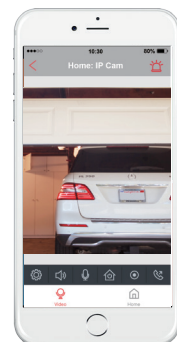



The Home8 app gives you complete access to security, safety, video, care and home control from your smartphone.

Home8 ActionView System Interactive and Collaborative Service



Get started with the Home8 app

1 Sidebar Menu

The Sidebar Menu icon ≡ on the upper left corner manages options such as editing device status, adding users/contacts for collaborative notification as well as viewing the history of notifications, etc.

2 Web Store

The system is easily expandable. There are different types of smart devices and IP cameras for comprehensive protection you can choose from.

5 VideoGram

Shows a list of triggered events and allows for the playback of event recordings. You can directly report or share the video via outlook/email, IM, FB, and other social medias from the app.

6 Automation & Energy Control

Remotely control your garage door or home appliances with our automation/Energy Systems. You can get video notifications, see it in action and monitor the power consumption of your devices.

7 Temperature

You can integrate your existing smart devices such as Amazon Echo, Nest and Honeywell etc. into the system and control them directly from Home8 app.

8 Medication

We offer medication reminder and dosage accuracy solution to help your loved one live an independent living.

9 Activity

Showing the timeline of motion and activities detected by the sensors/cameras.

10 Care24 GPS

Allows the system owner to locate individuals with the Care24 app. The Care24 App utilizes the user's smartphone as a fall detector, panic button, GPS locator and geofence.

11 User Management

Using simple smartphone number input, you can easily add Authorized Users, Emergency contacts, and Local Authorities for different access levels.

3 Device Management

You can easily add new devices to the system with a simple QR code scan. We also provide real time device and battery status.

Main Menu:

4 Video Verification & Action Control

You can verify event in real time via camera and control automation devices such as light, thermostat and garage door at the same time.

Multiple location video monitoring and alarms can be aggregated to the home8 smartphone app, and you can swipe the mobile screen for more videos.

aggregated to the home8 smartphone app, and you can swipe the mobile screen for more videos.

For more IP camera options, please visit home8alarm.com/store.

Upgrade to premium service to enjoy video recording, reporting, sharing, direct calling from your smartphone.

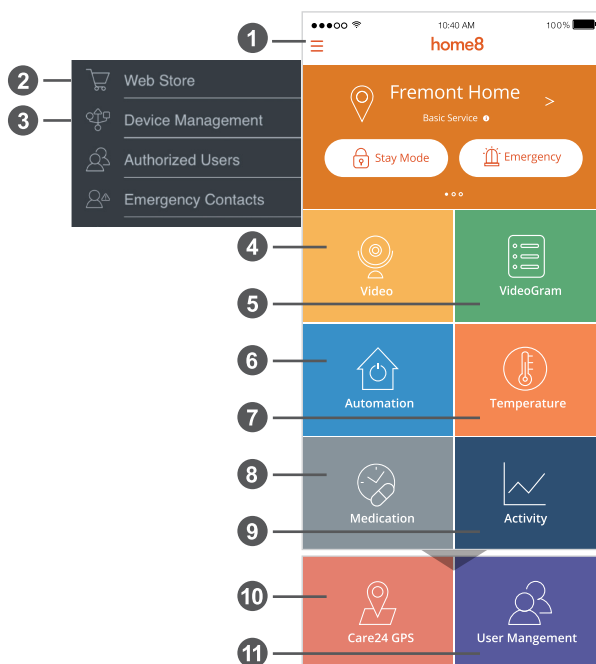

System Expansion

Purchase Video, Security, Safety and Care add-on devices online at <https://store.home8alarm.com>

Video Monitoring



Mini Talking Camera



Mini Outdoor Full HD Camera

Security



Motion Sensor



Valuable Tracking Sensor

Safety



Heat Alert Sensor



Water Leak Sensor

Care



Medical Alert Device



Fall and Medical Alert Device

Control



Garage Door Control Button



Smart Plug